

## 59-62 Rear Strut Rod

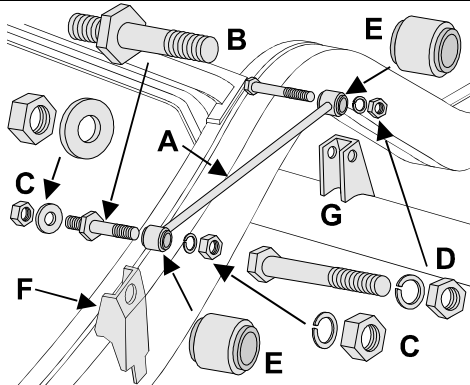

- A** 59-62 Rear Strut Rod **2 reqd**  
Strut Rod with 2 bushings. 7503143 **84.50**  
Replacement Rod & Bushings 7503216 **59.75**
- B** 59-62 Front Mounting Stud **2 reqd** 7503144 **25.00**
- C** 59-62 Rod Front **8 Piece** Mount Kit with 4 lock nuts & 4 high strength washers **Does 1 car** 7503146 **4.25**
- D** 59-62 Strut Rod Rear **6 Piece** Mounting Kit  
Includes 2 **★** Grade 300 Bolts & 2 lock washers & 2 lock nuts. **Does 1 car.** 7503147 **8.00**
- E** 59-62 OEM Strut Bushing **4 reqd** 7503145 **14.75**
- E** 59-62 Replacement Bushing **4 Pcs** 7503225 **21.50**
- 59-62 Proper Gauge Steel Strut Rod Mounting **Brackets:**
- F** Frame Mounting Bracket **2 reqd** 7503150 **54.95**
- G** Axle Mounting Bracket **2 reqd** 7503152 **31.00**

## 59-62 Rear Sway Bar

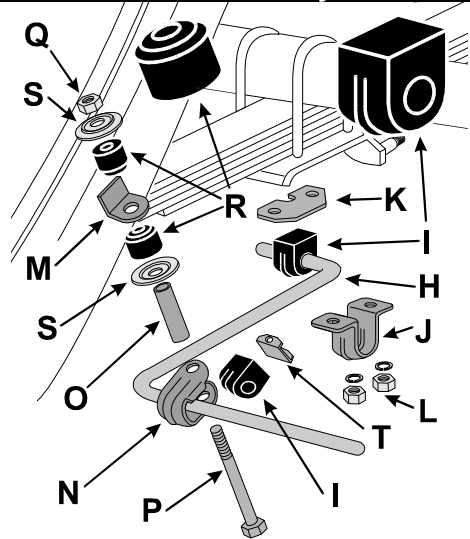

- H** 59-62 Rear Sway Bar **O/S** 7503149 **169.00**
- H** 59-62 Replacement Sway Bar **O/S** 7503218 **159.00**
- I** Authentic Rubber Bushing Use 2 at the Inner locations and 2 at the outer locations **4 reqd** 7242204 **13.75**
- J** 59-62 Sway Bar Outer Bushing **Bracket**  
Mounts outer end bushings to the bottom of the leaf spring. **2 reqd** 7240225 **15.00**
- K** 59-62 Outer Sway Bar Bracket **Spacer**  
**2 reqd** 7503175 **7.00**
- L** 59-62 Outer Bracket To Frame **8 Piece** Mounting Kit with 4 nuts & 4 lock washers. **Does 1 car** 7503174 **3.00**
- M** 59-62 Sway Bar Inner Mounting **Bracket** weld this part to the inboard frame rails. **2 reqd** 7503176 **12.45**
- N** 59-62 Sway Bar Inner Bushing Mounting **Bracket**  
Mounts to link bolt. **2 reqd** 7503177 **12.00**
- O+P+Q+R+S** Link Kit **Does 1 car** 7240255 **15.00**
- P** 59-62 Bar Link Bolt **2 reqd** 7240210 **3.50**
- Q** 59-62 Link Bolt Nut **2 reqd** 7240108 **0.95**
- R** 59-62 Link Grommet **8 Piece** Set 7240109 **7.75**
- S** 59-62 Grommet Steel Retainer **8 Piece** Set  
Thick steel like factory. Not those thin "Roosevelt"  
Dime parts. **Does 1 car.** 7240110 **7.50**
- T** Inner Bracket Spacer **2 reqd** 7503178 **8.40**

## Suspension Tools

147

### Suspension Tools

**A 53-82 Precision Dial Indicator Set**  
Includes case with all the attachments needed to measure hole depths and the end play on bearings in the wheels, differential, transmission etc. Measures in thousandths of an inch. 8802264 **Disc**

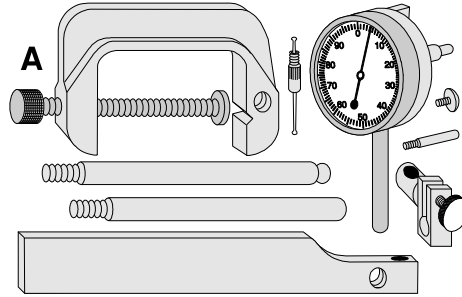

**B 65-82 Rear Spindle Removal Press**  
Permits removal of the most stubborn frozen rear spindle without hammering. Allows the spindle to be pressed out of the housing with or without removing the control arm. Includes heavy steel construction spindle press plate with press screw, mounting hardware, spindle thread protector cap and instructions. 8802266 **189.95**

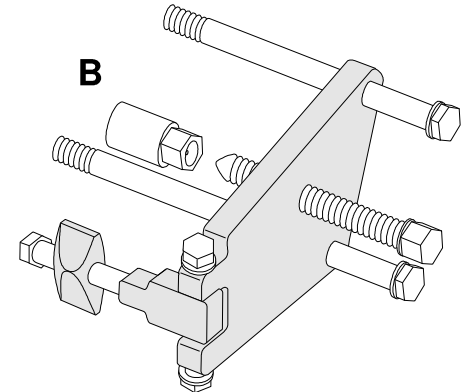

**C 63-82 Rear Spindle Bearing Puller**  
Permits removal of the outer wheel bearings & race from the rear spindle with or without removing the rear rotor. Instructions & Allen key included. 8802260 **134.00**

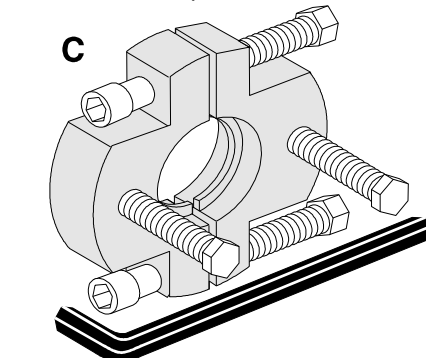

**D 63-82 Control Arm Bushing Mount Tool**  
Compresses rear control arm bushings so that the bushing retainer tube can be flared out over the special beveled control arm retainer plates. Includes press, special flaring punch & instructions. 8802262 **52.95**

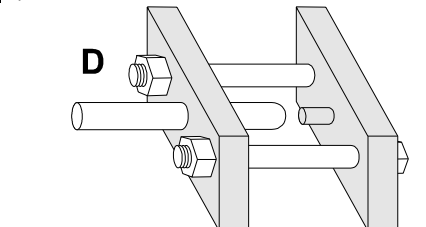

**E 63-82 Rear Spindle Knocker Tool**

Spin this tool onto the threaded end of the spindle until it bottoms out on the spindle's shoulder just beyond the threaded portion. Prevents damage to the threads when knocking out with a hammer. **TIP:** always wear goggles for eye protection and use a Lead hammer to prevent metal splinters. 8802252 **18.75**

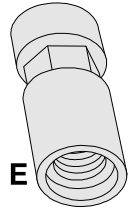

**F 63-82 Race & Grease Seal Mount Tool**  
Permits proper installation of the rear spindle wheel bearing race and oil seals in the spindle support without damage. 8802256 **Disc**

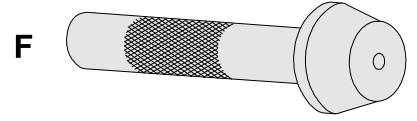

**G 63-82 Rear Spindle Mount Tool**  
Mounts to the spindle threads and allows it to be pulled into the spindle support without damaging the bearings or oil seals. Instructions included. 8802258 **64.95**

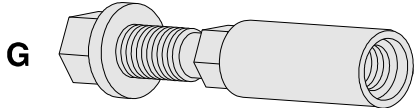

**H 63-82 Rear Spindle Shim Set Up Tool**  
This precision tool eliminates the need to repeatedly install & remove the rear spindle to determine the number of shims needed for rear wheel bearing clearance. Install this tool in the rear spindle support, slide on the bearings, spacer & measure the clearance to identify the number of shims. Instructions included. 8802254 **95.00**

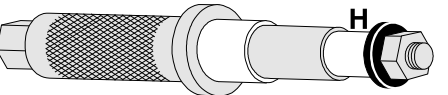

**I 63-82 Shock Support Remover Tool**

Spin this tool onto the threaded end of the shock & strut shaft to protect the threads when hammering it from the lower spindle support. **TIP:** use a Lead hammer to prevent metal splinters & wear goggles for eye protection 8802250 **18.75**

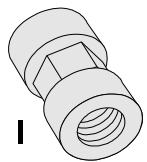

**J 63-82 Wheel Bearing Grease Tool**

Mount this tool onto the threaded end of the rear spindle before attaching the spindle flange. Attach a grease gun to the grease fitting and you will be able to pack the inner and outer rear wheel bearings with sufficient grease. 8802268 **14.95**

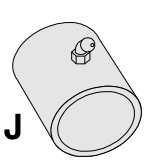

## WARNING

Beware cheaper mounting hardware. **It's weaker!**  
Our mounting bolts have the high tensile strength required for these structural applications.

**TIP** Identify the strength of a bolt by counting the number of lines on the head. The greater the number of lines, the greater the tensile strength.

**No lines** = Grade 260 strength = **WEAK**  
**3 lines** = Grade 280 strength = **STRONG**  
**5 lines** = Grade 290 strength = **STRONGER**  
**6 lines** = Grade 300 strength = **VERY STRONG**

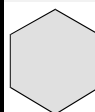

**GRADE 260**

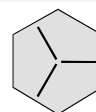

**GRADE 280**

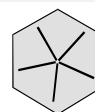

**GRADE 290**

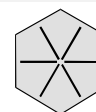

**GRADE 300**