

Speedometer Drive

The drive for the dash speedometer consists of a Gear - mounts in the side of the transmission

Fitting - holds the above gear & is threaded for attachment of the speedometer cable

Fitting Seal - mounts on the fitting to prevents an oil leak from the transmission case.

Fitting Retainer - mounts the fitting to the transmission

Screw & Lock Washer - screws & locks !

Speedometer Drive except Turbo 400

A 61-81 Speedometer Drive Gears

These are listed at the bottom of the Previous Page.

B 61-81 Speedometer Fitting

except Turbo 400 4337104 19.40

C 55-81 Seal except Turbo 400

4337110 2.95

D 55-81 Retainer except T-400

4337114 7.50

E 55-81 Mounting Screw & Lock Washer

except T-400 4337116 1.85

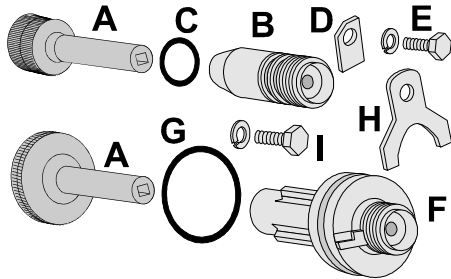

Speedometer Drive with Turbo 400

A 61-81 Speedometer Drive Gears

These are listed at the bottom of the Previous Page.

F 68-77 Speedometer Fitting with Turbo 400

using a 35-39 tooth gear 4337106 47.75

using a 40-45 tooth gear 4337108 47.75

G 68-77 Fitting Seal Turbo 400

4337112 3.00

H 68-77 Retainer with Turbo 400

4337118 8.50

I 68-77 Mounting Screw & Lock Washer

with Turbo 400 4337120 1.85

Speedometer Cables

All cables include Black plastic covered outer steel casing, inner drive core & end nuts & fittings installed.

S These have a Steel Spiral Outer Casing.

B Black Casing Select from...

G Gray Casing Delco Repra

53-55 All Speedo (Delco are B) S 9755102 34.50

56-59 Automatic 9750124 51.00 S 9755102 34.50

56-59 3 Speed 9750124 51.00 S 9755104 34.50

58-62 4 Speed 9750124 51.00 B 9755106 26.50

60-62 All 9750124 51.00 G 9755108 30.00

63-64 4 Speed or, 9752110 42.00 B 9755106 26.50

63-67 Automatic or, 9752110 42.00 B 9755110 25.50

66-67 3 Speed 9752110 42.00 B 9755110 25.50

63-65 3 Speed 9752112 34.75

65-66 4 Speed 9750124 43.00 B 9755106 26.50

67-68 4 Speed 9752116 44.60 B 9755106 26.50

69-77 4 Speed 9752124 43.00 B 9755112 23.75

Auto or 3 Speed:

68 Upper 9752120 35.00 B 9755114 25.50

69-77 Upper 9752128 44.50 B 9755114 25.50

68-77 Lower 9752126 49.50 B 9755116 28.50

78-81 4 Sp no Cruise 9752136 43.00 B 9755118 27.50

78-82 Auto no Cruise 9752138 35.50 B 9755118 27.50

78-82 Cruise Upper 9750134 34.50 B 9755120 22.50

78-82 Cruise Lower 9752140 39.75 B 9755122 28.00

Delco Cable Repair Kit

53-82 Cable Repair Kit Includes 62" long inner steel cable and repair tip. Allows replacement of your old factory steel core for cables up to 70" long. Ous is Real Delco

Cut as required. 9751103 22.95

Cable Grommets

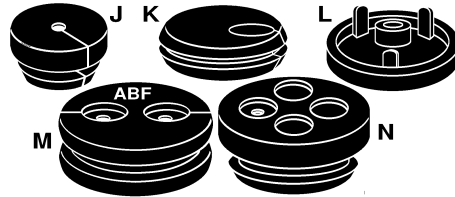

J 53-62 Speedo & Tach Cable Grommet or 53-62 speedo cable 2 reqd or 53-61 tach cable except F.I. 2 reqd or 62 tach cable 1 reqd 9760110 3.50

K 58 Fuel Injection Tach Cable Grommet 7001058 22.00

L 63-82 Cable Grommet with 3 steel prongs: 63-64 tach cable 1 reqd; or 63-82 speedo 1 reqd 9218220 19.50

M 65-67 Tach & Speedo Cable Grommet Exact repro, even has the ABF logo on the surface as factory, but without the 2 bogus dimples found on the brand x replacement part. 9751130 15.00

N 68-74 Tach Cable Grommet 4 holes, also carries oil pressure line, back-up switch wires, power window & automatic trans wiring as required. 9751074 8.55

62 Tach Cable Boot includes Steel Firewall Retainer needed to hold boot to firewall Tach Cable Boot NOS 9750127 75.00 Tach Cable Boot Repra 9750121 19.45

55-61 Tach Drive Seal

55-61 Tach Drive Housing Seal only

Die cut fiber seals the tach drive cover to the plate on the generator. Helps prevent loss of lubrication to these expensive gears. 9751101 3.75

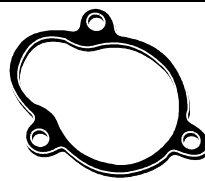

55-61 Tach Drive Unit on the Generator Includes rear cover, mounting plate with 3 screws, bushing & drive gear shaft. 9751115 102.50

Tach Drive Unit with Gears Repra 9751160 159.95

55-61 Repra Gear NOS Gear

Fiber Drive Gear 9751161 26.95 9751116 41.50

Steel Tach Gear 9751162 35.50 9751117 50.00

Tach Cables

All cables include plastic/steel covered outer steel casing, inner drive core & end nuts & fittings installed.

S These have a Steel Spiral Outer Casing.

B Black Casing Select from...

G Gray Casing Delco Repra

53-55 6 Cylinder (Delco are B) S 9755124 48.50

55-57 V-8 9750122 35.00 S 9755126 35.50

58-59 9750124 51.00 S 9755128 35.50

60-61 9750124 51.00 B 9755106 26.50

62 9750120 35.00 G 9755130 31.00

63-64 9750130 42.00 G 9755132 23.55

65-67 9750130 42.00 B 9755134 23.55

68 only NOS GM 9750132 75.00 B 9755134 23.55

69-74 9750134 34.50 B 9755136 21.50

69-74 Imported Tach Cable B 9755098 18.50

53-82 Cable Lube

Tach, Speedometer or Cruise Cable Lube

Apply this lube to all new or used cables to assure trouble free operation. This lubricant is specially formulated to withstand a wide range of temperatures from sub-freezing to sub-tropical, while resisting rust and corrosion. It is the equivalent to the factory lubricants. Does several cables.

1/2 Fluid Ounce Tube 9753101 5.95

63-67 Tire Carrier

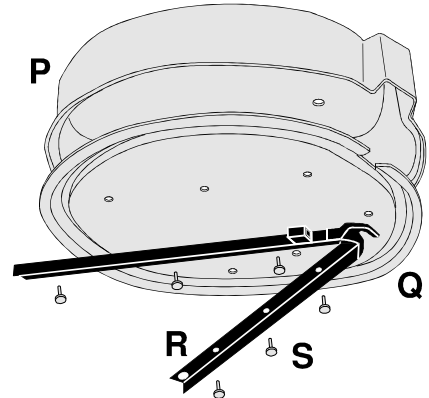

Match Molded Fiberglass Smooth on both sides

Tire Carrier Upper Tubs & Trays are UPS 20/S:

P 63 Authentic Upper Tire Tub 7632123 249.00

63-67 Replacement Upper Tire Tub 7632157 229.00

P 64-67 Authentic Upper Tire Tub 7632125 249.00

64-67 NOS GM Upper Tire Tub 7632128 0.00

63-67 Tub to Frame Support Mounting 8 Piece Kit Includes 4 hex washer head bolts with starter points & 4 flat washers. Does 1 car. 7632151 3.50

Q 63-67 Authentic Lower Tray O/S 7632124 184.00

63-67 Replacement Tray O/S 7632158 165.00

R Tire Carrier V-Shaped Support Brackets:

63 V-Shaped Bracket 7632126 67.50

64-67 V-Shaped Bracket 7632127 67.50

S 63-67 V-Bracket Mount Rivet 6 Piece Set Does 1 car.

Ours are not the hard repros. NOS 7632150 2.50

? Purchase a Complete Tire Carrier and Save

P+Q+R 63 Authentic Spare Tire Carrier Kit UPS 20/S

includes Lid, Tub & V-Bracket 7632101 474.95

63-67 Replacement Spare Tire Carrier Kit UPS 20/S

includes Lid, Tub & V-Bracket 76321 469.95

P+Q+R 64-67 Authentic Spare Tire Carrier Kit UPS O/S

includes Lid, Tub & V-Bracket 7632102 474.95



These are OEM "ARMOR" Headed Bolts

T 63-66 Front Tire Bolt with Shoulder Cadmium plated.

use with steel wheel rims; 2 reqd 7632115 43.95

U 63-67 Front Tire Bolts with Nut

use with aluminum wheels, gold or redline tires, all 67 or radial tires. Not repro. 2 reqd 7632116 35.00

V 63-67 Rear Lock Bolt 9 Piece Set

With everything needed to mount rear bolt includes plated lock bolt, plated barrel nut, spacer, roll pin & 4 piece set of plated mounting hardware except the cross bracket 7632117 69.50

W Early 63 Spare Tire Lock Bolt

Authentic design with thinner hex head, without the shoulder below the threaded portion & a symmetrical cone below the head. Cad plated. 7632120 20.00

Trip Meter Cable

63-Early 64 Trip Cable (brass nut) 9751158 47.75

Late 64-67 Trip Cable (aluminum nut) 9751159 47.75

68-77 Trip Cable & Casing 9751108 62.00

63-77 Trip Cable Reset Knob repra 9751157 7.50

63-77 Trip Cable Reset Knob NOS 9751105 10.00

63-77 Cable Mounting Nut 9751106 Disc