

**Basic 63-67 Weatherstrip Kits**

Coupe 13 Piece Basic Weatherstrip Kit includes: 2 Door Mains, 2 Door Auxiliary, 1 set Door Handle, 2 Hinge Pillar, 2 Coupe over Door on the Body, 1 Hood  
 63 13 Piece Weatherstrip Kit 1002349 222.00  
 64-65 or 67 13 Piece Weatherstrip Kit 1002312 214.00

66 Coupe 11 Piece Basic Weatherstrip Kit  
 As above without Hinge Pillar 1002313 188.00

**Deluxe 63-67 Weatherstrip Kits**

64-65 or 67 Coupe 20 Piece Deluxe Kit includes contents of the above Basic Kits plus 2 Front and 2 Rear Vent Window, 2 Horizontal Outer Window Seals, 1 Windshield Channel. 1002316 397.00

63 Split Window 22 Piece Deluxe Weatherstrip Kit includes contents of the above Deluxe Kit plus 2 Split Window W/Strips 1002315 473.00

66 Coupe 18 Piece Deluxe Weatherstrip Kit includes contents of the above Deluxe Kit except the Hinge Pillars 1002317 369.00

**63-67 Coupe Door Weatherstrip**

**A 63-67 Coupe Door Weatherstrip**

Authentic profile with dual air cells, both large size, not like the small air cell replacements. These are "No Puff" & will not cause the doors to bulge out like the replacements. Include the upper rear molded corner so that it fits properly around the tight curve at the top rear of the door.

LH Molded Coupe Main Weatherstrip 1069231 21.25  
 RH Molded Coupe Main Weatherstrip 1069232 21.25  
 LH+RH Molded Coupe Main Pair 1069253 42.00

**B "L" Shaped Door Auxiliary W/S**

63 LH 1069406 15.25 63 RH 1069407 15.25  
 64-67 LH 1069431 14.25 64-67 RH 1069432 14.25

**C Auxiliary Weatherstrip Push-In Fastener**

63-66 Plastic 8 Piece Set Does 1 car. 1069435 3.95  
 67 Steel 8 Piece Set Does 1 car. 1069436 4.95

**D Coupe Body Weatherstrip Over the Door**

A quality USA part - not a foreign imitation.  
 63-67 LH Weatherstrip over Door 1069441 55.50  
 63-67 RH Weatherstrip over Door 1069442 54.50  
 63-67 LH+RH over Door Pair 1069260 117.50

**E Over Door Weatherstrip Mount Screws**

63 14 Piece Screw Set 1069433 4.40  
 64-67 14 Piece Screw Set 1069434 4.60

**F 63-67 Coupe Hinge Pillar Weatherstrip**

63-67 LH Hinge Pillar Weatherstrip 1069445 24.00  
 63-67 RH Hinge Pillar Weatherstrip 1069446 24.00  
 63-67 LH+RH Hinge Pillar Pair 1069261 48.25

**G 63-67 Pillar Weatherstrip Mtg 6 Pc Set**

Includes 4 Black plated screws & 2 pop rivets.  
 Does 1 car. 1069440 2.95

**H Door Lock Rod Anti-Rattle**

This White woven tubular fabric slips over door the door lock rods. Pair Does 1 car. 1071015 9.50  
 63-67 Lock Rod Clip 6 Piece Set 1045001 6.00

**Vent Window**

**I 63-67 Coupe Front Vent Weatherstrip**

USA LH 1065221 45.00 RH 1065222 45.00  
 China LH + RH Front Vent W/S pair 1069263 69.50

**J 63-67 Coupe Rear Vent Weatherstrip**

Molded rubber with steel inserts as required.  
 USA LH 1065223 24.95 RH 1065224 24.95  
 China LH 1065221 22.50 RH 1065222 22.50

**Weatherstrip Adhesive**

Select from two quality "3M" Brand Adhesives in 5 oz. tubes. The Yellow color is authentic for early models.  
 Yellow "3M" @ 1069585 9.95  
 Black "3M" @ 1069584 11.95

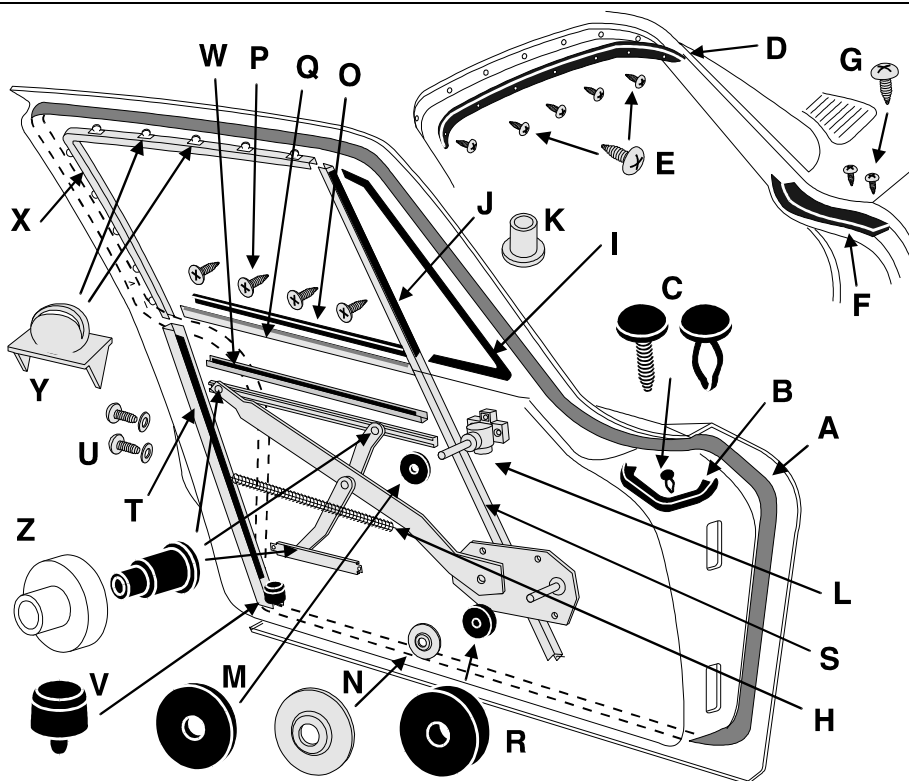

**K 63-67 Coupe Vent Hinge Pivot Rivets**

This Steel rivets must be replaced when changing the vent W/S. Pair Does 1 car. 1065229 4.00

**63-67 Vent Window Regulator Gear**  
 with split washer, bolts. 2 reqd. 1065219 0.00

**L 63-67 Coupe Vent Window Regulator**  
 Regulator assemblies include the shaft, gear & housing that are used to open the vent window.  
 63-64 LH 1065237 139.50 RH 1065238 139.50  
 65-67 LH 1065239 139.50 RH 1065240 139.50

**M 63-67 Vent Window Shaft Seals**  
 Die cut sponge rubber. Does 1 car. 1065220 3.50

**N 63-67 Crank Handle Nylon Bearings**  
 Prevents handle from damaging the door panel.  
 Window Cranks 1 pair reqd  
 Vent Cranks . Pair 1 pair reqd 1079724 5.95

**Side Door Glass**

**O 63-67 Coupe Horizontal Outer Glass Seals**  
 Includes LH & RH authentic extruded rubber seals with steel core, and these are already die stamped for the proper hole location. Not foreign universal replacements these - only fit 63-67 coupes. . Pair Does 1 car 1071040 21.75

**P 63-67 Outer Seal Mounting Screw Set**  
 8 Piece set. Does 1 car 1071049 3.00

**Q 63-67 Coupe Horizontal Inner Glass Seals**  
 These LH & RH seals include the "CAT WHISKER" are dieamped steel, notched & preformed; they mounts to the top edge of the door panel. Select from...  
 63-67 Coupe Inner Horizontal Seals  
 NOS in the old Blue & White GM packages.  
 Limited supply. Pair 1071005 80.00

**R 63-67 Window Crank Shaft Seal**  
 Die cut sponge rubber. Pair Does 1 Car. 1079740 3.95

**S 63-67 Front Window Run Channel**  
 These rigid channels have a chrome bead on each edge and are lined with "Cat Whisker".  
 Pair Does 1 car. 1071048 41.50

**T 63-67 Rear Channel Black Fabric Liners**  
 Glue into the rear channels. 2 reqd 1071022 6.00

**63-67 Door Striker Mount Screw 6 Piece Set**  
 Does 1 car. 1045004 12.00

**U 63-67 Rear Channel Mounting 8 Piece Kit**  
 with 4 screws & 4 star washers needed to mount the rear lower channels to door. Does 1 car. 1069430 2.75

**V Glass Rear Channel Lower Bumper**  
 Molded rubber bumper cushions the glass at the bottom of the channel. Pair Does 1 car. 1071059 3.00

**W 63-67 Glass to Sash Liner Tape 2 to 4 reqd**  
 Holds door glass in the lower horizontal frame sash and the vent glass in the vent frame. 1071060 7.50

**X Upper Horizontal & Rear Vertical Channel**  
 The door glass runs in these formed flexible channels with a chrome bead on each edge, lined with "Cat Whisker".  
 UPS O/S. Pair Does 1 car. Select from...  
 63 Formed Flex with mounted Clips 1071043 112.95  
 64-67 Formed Flex with mounted Clips 1071044 94.50

**Y Flexible Channel Mounting Clip Set**  
 20 piece set. Does 1 car. 1071045 10.50

**Clip Installation Tip**

The easiest method to locate these clips is to first snap them into the slotted holes in the door recess. Next, take your formed channel and gradually push it into the door recess, right onto the barbs that protrude from the mounting clips. Push the channel into place with a small narrow block of wood, so that the barbs puncture the channel. Use care so that you do not puncture your finger. Lastly, bend the barbs over to fasten them to the channel.

**Z Regulator Roller & Rivet Set**

If these rollers have flat spots, are cracked or are missing, you cannot raise or lower the glass with ease. Twelve piece set includes 6 nylon rollers for the glass guides & 6 special mounting rivets. Does 1 car. 1079754 12.00

**Window Glass Regulator Toothed Gear**  
 Manual Window Regulator Gear 1077747 27.25  
 Power Window Regulator Gear 1077738 27.25

**Power Window Conversion Kit**  
 Includes Regulators, Motors, Conduit, Harness, Switches  
 Does 1 car. 1071190 648.00