

Basic 63-67 Weatherstrip Kits

Convertible 12 Piece Weatherstrip Kit includes 2 Door Mains, 2 Door Auxiliary, 1 Set Door Handle, 2 Windshield Post with Hinge Pillar, 1 Deck Lid, 1 Hood
63 12 Piece Weatherstrip Kit 1002347 **244.00**
64-67 12 Piece Weatherstrip Kit 1002311 **244.00**

Deluxe 63-67 Weatherstrip Kits

Convertible 19 Piece Deluxe Weatherstrip Kit includes the above Basic Kits – plus 1 Windshield Channel, 2 Front Vent Window, 2 Rear Vent Window and 2 Horizontal Outer Window Seals.
63 19 Piece Weatherstrip Kit 1002341 **439.00**
64-67 19 Piece Weatherstrip Kit 1002314 **439.00**

63-67 Door Weatherstrip

A 63-67 Convertible Door Main Weatherstrip

These are quality U.S.A. manufactured parts with the authentic profile & molded ends with steel inserts as OEM.
LH Conv Door Main Weatherstrip 1069223 **54.75**
RH Conv Door Main Weatherstrip 1069224 **54.75**
LH+RH Conv Door Mains Pair 1069252 **108.95**

B Door Main Weatherstrip Run Mount Kit

8 Piece set includes 4 washers & 4 Black plated screw. Also mounts rear vertical channels.
Does 1 car. 1069430 **2.75**

C "L" Shape Door Auxiliary Weatherstrip

63 LH 1069406 **15.25** **63 RH** 1069407 **15.25**
64-67 LH 1069431 **14.25** **64-67 RH** 1069432 **14.25**

D Auxiliary Weatherstrip Push-In Fastener

8 Piece set. **Does 1 car, both doors.**
63-66 Plastic Fastener 8 Piece Set 1069435 **3.95**
67 Steel Fastener 8 Piece Set 1069436 **4.95**

E 63-67 Convertible Windshield Post & Hinge Pillar Weatherstrip

Don't be fooled by those cheaper imported parts that have a granular surface texture that will form little balls of rubber when rubbed between your fingers!
LH & RH Set Pair Does 1 car 1069437 **99.00**

F Post & Pillar Weatherstrip Mount Screws

Black plated **4 Piece set. Does 1 car** 1069439 **2.75**

G 63-67 Door Lock Rod Anti-Rattle

This White woven tubular fabric slips over door the door lock rods. **Pair Does 1 car** 1071015 **9.50**
63-67 Lock Rod Clip 6 Piece Set 1045001 **6.00**

Convertible Vent Window

H Front Vent Window Weatherstrip USA

Authentic molded rubber with steel inserts as factory.
63-67 LH 1065231 **48.50** **63-67 RH** 1065232 **48.50**

I 63-67 Rear Vent Window Weatherstrip

Molded rubber with steel inserts & replica steel tabs to fold over when installed.
LH USA 1065233 **24.95** **RH USA** 1065234 **24.95**
LH China 1069219 **22.50** **RH China** 1069220 **22.50**

63-67 Vent Window Regulator Gear

with split washer, bolts. **2 reqd.** 1065219 **0.00**

J Convertible Vent Window Regulator

Regulator assemblies include the shaft, gear & housing that are used to open the vent window. **Specify year**
63-64 LH 1065239 **139.50** **63-64 RH** 1065240 **139.50**
65-67 LH 1065241 **139.50** **65-67 RH** 1065242 **139.50**

K 63-67 Vent Window Shaft Seal

Die cut sponge rubber. **Pair Does 1 car.** 1065220 **3.50**

Side Door Glass

L Horizontal Outer Glass Seals

Includes LH & RH Pair authentic extruded rubber seals with steel core & die stamped for the proper hole location. **NOT the universal replacements. Does 1 car.** 1071050 **21.75**

M Outer Seal Mounting Screw Set

8 Piece Set. Does 1 car. 1071049 **3.00**

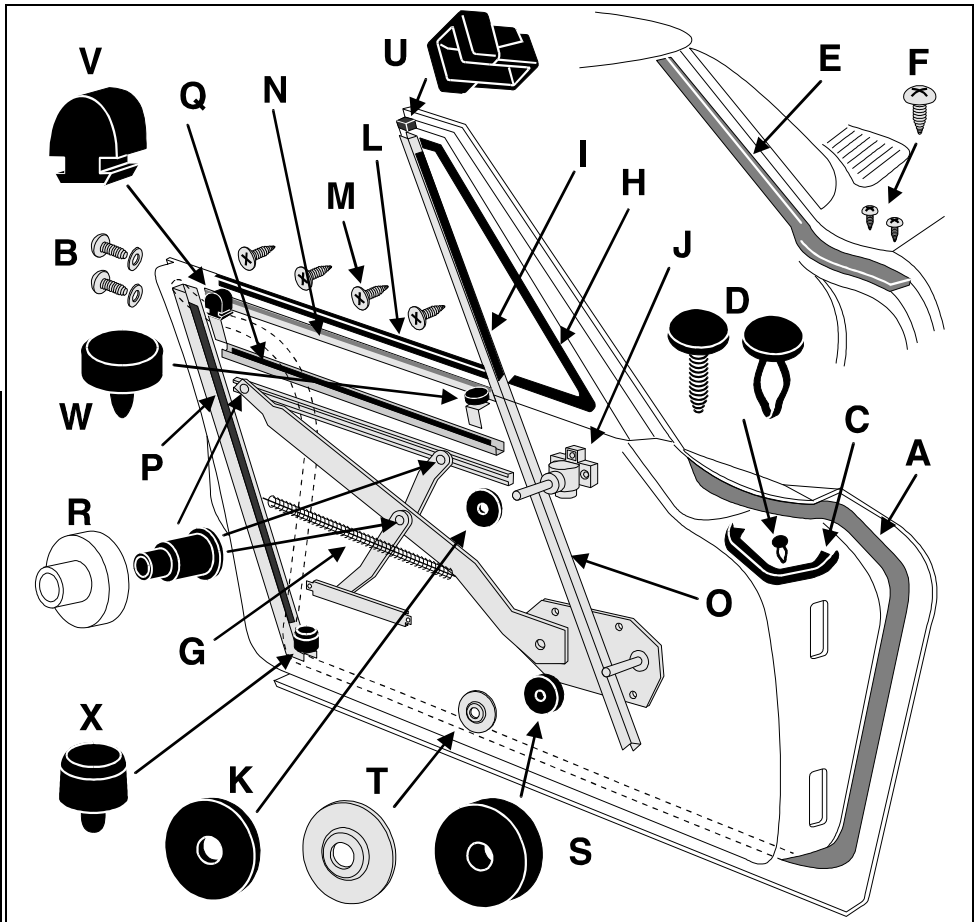

N 63-67 Horizontal Inner Glass Seals

These LH & RH seals include the "CAT WHISKER" are die stamped steel, notched & preformed; they mount to the top edge of the door panel. **Does 1 car.**
63-66 Inner Seal & Whiskers Pair 1071051 **44.95**
67 Inner Seal & Whiskers Pair 1071052 **44.95**

O 63-67 Front Vertical Glass Run Channels

These rigid channels have a chrome beaded edge & are lined with "Cat Whisker". **Pair** 1071053 **41.00**

P 63-67 Rear Channel Liners

Black material, glue these into the rear channels. Attach with "3M" Black W/S adhesive at the bottom of this page. **2 reqd** 1071022 **6.00**

Q 63-67 Glass to Sash Liner Tape

Holds the side door glass in the lower horizontal window frame sash or the vent window glass in the vent frame. **2 to 4 reqd.** 1071060 **7.50**

R 63-67 Regulator Roller & Rivet Set

If your rollers have flat spots, are cracked or are missing, you cannot raise or lower the side door glass with ease. Twelve piece set includes 6 nylon rollers for the glass guides & 6 special rivets for attachment. **Does 1 car.** 1079754 **12.00**

Window Glass Regulator Toothed Gear

Manual Window Regulator Gear 1077747 **27.25**
Power Window Regulator Gear 1077738 **27.25**

S 63-67 Window Crank Shaft Seal

Die cut sponge rubber. **Pair Does 1 car.** 1079740 **3.95**

T Crank Handle Nylon Bearings

Prevents handle from damaging the door panel. **Pair Window cranks handles 1 pair reqd** 1079724 **5.95**
Vent cranks handles 1 pair reqd

U 63-67 Glass Front Upper Rubber Stop

These rubber covered steel inserts mount at the top of the front vertical runs. Prevents door glass from coming out of the track. **2 reqd** 1071054 **11.95**

V 63-67 Conv. Glass Rear Upper Bumper

Don't be fooled into purchasing an inauthentic late model replacement clutch pedal bumper. This one is authentic molded rubber, rounded on top & properly fits in the slotted bracket. **Pair Does 1 car.** 1071055 **2.95**

W Glass Front Upper Window Bumpers

Molded rubber prevents door glass from coming out of the track. **Pair Does 1 car.** 1071056 **3.95**

X Glass Rear Channel Lower Bumper

Molded rubber bumper cushions the glass at the bottom of the channel. **Pair Does 1 car.** 1071059 **3.00**

63-67 Door Wedge 16 Piece Set

Includes 2 Gray plastic wedges to mount on the body, plus 2 Zinc die cast wedges to mount on the door, plus 4 steel shims & 8 mounting screws. An identical set of these wedges is also used on the convertible top deck lid. **1 to 2 sets reqd** 1069467 **38.00**

63-67 Door Striker Mount Screw 6 Piece Set

Does 1 car. 1045004 **12.00**

Weatherstrip Adhesive

Select from two quality "3M" Brand Adhesives in 5 oz. tubes. The Yellow color is authentic for early models.
Yellow "3M"® 1069585 **9.95**
Black "3M"® 1069584 **11.95**

Door Handle Gaskets



S 56-62 Handle Gasket 4 Piece Set 1051519 **4.00**
T 63-64 Handle Gasket 4 Piece Set 1051525 **3.75**
U 65-67 Handle Gasket 4 Piece Set 1051529 **3.75**

Power Window Conversion Kit

Includes Regulators, Motors, Conduit, Harness, Switches **Does 1 car.** 1071190 **648.00**