

Clutch Seals

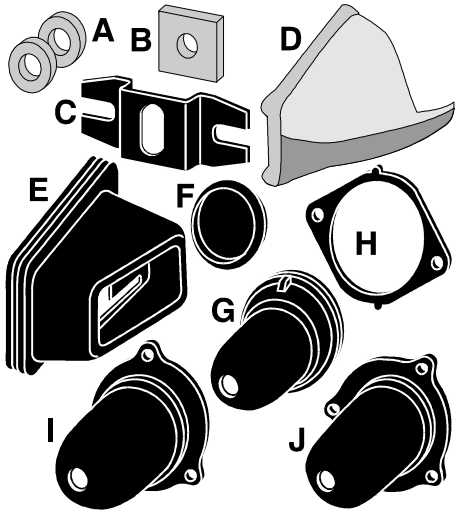

- A** 55-82 Clutch Cross Shaft Grease Seal
Thick die cut gray industrial felt, just like the factory seals. Pair 3851204 3.50
- B** 55-62 Clutch Push Rod Firewall Seal
Ours is thick dense die cut gray felt, just like the original factory seals. 3787701 4.25
- C** 55-62 Firewall Seal Retainer 7 Piece Kit
Includes steel retainer plus 2 screws, 2 flat & 2 lock washers. Paint as reqd 3787702 12.00
- D** 56-60 Suede Leather Fork Boot includes wire retainer to mount in a cast iron bell housing. 3787204 31.50
- D** 60-62 Rubber Fork Boot mounts in an models with an Aluminum bell housing. 3787206 35.00
- E** 63-81 Clutch Bell Housing Fork Boot
Molded rubber made in the USA; does not have that Offensive Odor like most foreign rubber. 3787302 16.95
- E** Clutch Bell Housing Fork Boot. China 3787301 10.00

- F** 63-81 Clutch Firewall Plug with Automatic
Molded plastic, snaps into firewall clutch rod hole on automatics. 3787709 2.00
- G** 63-Early 65 Clutch Rod Firewall Boot
This authentic molded rubber boot mounts to the firewall using the following retainer. Use until 65 VIN # 11,760 approximately. 3787703 9.45
- H** 63-Early 65 Clutch Boot Retainer
Mounts the above boot to the firewall & includes 2 indented hex head tapping screws. Use until 65 VIN # 11,760 production approx. 3787704 6.00
- I** 65-67 Clutch Rod Firewall Boot
Authentic molded rubber, with an integral steel retainer molded right into the rubber. This design has 3 mounting holes. 3787705 11.50
- 65-67 Clutch Inner Firewall Mounting Plate NOS
Rivets to the inner firewall. 3787724 25.00
- 65-81 Boot Mounting 3 Piece Screw Set
Indented hex tapping screws. 3787815 1.95
- J** 68-81 Molded Rubber Firewall Boot
Includes a steel retainer, molded right into the rubber with 3 mounting holes. Repro 3787207 18.00
- J** Above 68-81 Clutch Boot NOS 3787706 0.00

63-81 Clutch Linkage

- A** 63 Clutch Fork Assembly NOS 3787102 0.00
- A** 63 Clutch Fork Assembly Repto 3787112 97.00
- A** 64-81 Clutch Fork Assembly USA 3787103 68.50
- A** 64-81 Clutch Fork Assembly China 3787116 59.75
- 57-81 Fork Repair Spring rivets to fork & allows it to pivot on bellhousing mtg stud NOS 3787104 25.00
- 57-81 Fork Repair Spring Repto 3787114 8.00
- B** 63-81 Throw Out Bearing aftermarket 3787108 28.50
- B** 63-81 Throw Out Bearing Delco 3787106 39.85
- C** 63-81 Clutch Fork Mounting Stud in Bell Housing NOS Fork Mounting Stud 3787201 12.75
- Repto Fork Mounting Stud 3787202 10.00
- Cross Shaft to Fork Push Rods
- D** 64-66 Fork Push Rod 327 NOS 3787403 19.50
- D** 64-66 Fork Push Rod 327 Repto 3787404 16.40

- D** 65-66 Fork Push Rod 396-427 or
- D** 67-81 Fork Push Rod all NOS 3787406 20.45
- D** above Fork Push Rod Repto 3787407 16.40
- E** 64-81 Fork Mounting Clevis Pin discontinued genuine GM not repro 3787405 4.00
- F** 64-81 Clevis Cotter Pin 3787408 0.90
- Cross Shafts mount between the frame & engine block.**
- G** 63-66 Cross Shaft 327 NOS 3851201 95.00
- G** 65-66 Cross Shaft 396 or 427 3851202 115.00
- G** 67-81 Cross Shaft NOS 3851203 125.00
- H** 63-81 Shaft Grease Fitting 3851213 1.95
- I** 63-81 Mount Stud on Block (73-81 repl) 3851207 18.25
- I** 73-81 Mount Stud on Block NOS 3851208 26.00
- J** 63-81 Mounting Stud Nylon Seat 3 Piece Set
Does 1 car. OEM not repro 3851205 7.50
- K** 63-81 "D" Shaped Retainer OEM 3851206 3.00
- L** 63-81 Felt Seals Pair 3851204 3.50
- M** 63-71 Frame Mtg Stud coarse NOS 3851209 9.50
- M** 63-71 Frame Mtg Stud coarse Repto 3851221 9.00
- M** 72-81 Frame Mtg Stud fine NOS 3851214 12.50
- M** 72-81 Frame Mtg Stud fine Repto 3851222 9.00
- N** 63-71 Stud Mounting Nut coarse 3851215 0.90
- N** 72-81 Stud Mounting Nut fine 3851219 0.90
- O** 63-81 Frame Stud Retainer Lock with 2 tabs to bend over frame stud mounting nut OEM 3851210 3.95
- P** Cross-Shaft Frame Mounting Brackets
63-79 Welds to Frame NOS 3851216 40.00
- 63-79 Welds to Frame Repto 3851220 25.00
- 80-81 Bolts to frame. (also fits 82) 3851217 20.00
- 78-81 Mounting Bolts for above. Pair 3851218 2.95
- Q** 63-67 Firewall Push Rod exc 396 GM 3787601 40.00
- Q** 68-81 Firewall Push Rod. 3787608 22.60
- R** 63-81 Push Rod Swivel OEM 3787605 35.00
- S** 63-81 Swivel Adjusting Nuts Pair 3787609 1.20
- T** 63-81 "R" Clip 3 Piece Set
Also used on shift linkage. 3787610 2.90
- U** 63-82 Rod Thick Spacer Washer 3787620 2.00
- V** 63-82 Rod Thin Flat Washer 3787621 0.90
- 63-81 Pedal Shaft Plastic Bushings:
W End Bushings 4 reqd 3787805 1.95
- X** Center Bushing 3787809 10.00
- Y** Clutch Or Brake Pedal Bumpers:
63-72 Pedal Bumper 2 reqd 3787804 2.00
- 73-82 Pedal Bumper 2 reqd 3787817 5.00
- Z** Brake-Pedal Return Springs
63-66 Black Spring 3451402 5.75
- 67-81 Orange Spring 3451403 5.75
- AA** 63-81 Shaft Retaining Clip 3787806 2.75
- BB** 63-66 Clutch Pedal with Shaft USA 3851223 72.00
- 63-66 Pedal Bracket with Pin USA 3851225 24.00
- BB** 67 Clutch Pedal with Shaft USA 3851224 79.00
- 67 Pedal Bracket with Pin USA 3851226 19.50
- BB** 68-79 Clutch Pedal with Pin 3787820 71.95
- BB** 80-81 Clutch Pedal with Pin 3787819 85.00
- CC** 63 Fork Rod Spring Repto 3787400 5.00
- CC** 63 Fork Rod Spring NOS 3787803 20.00
- DD** 64-81 Fork Rod Springs 2 reqd 3787501 3.50
- EE** 63-67 Firewall Return Spring 3787807 6.00
- DD** 68-81 Firewall Return Spring 3787808 6.50

- W** End Bushings 4 reqd 3787805 1.95
- X** Center Bushing 3787809 10.00
- Y** Clutch Or Brake Pedal Bumpers:
63-72 Pedal Bumper 2 reqd 3787804 2.00
- 73-82 Pedal Bumper 2 reqd 3787817 5.00
- Z** Brake-Pedal Return Springs
63-66 Black Spring 3451402 5.75
- 67-81 Orange Spring 3451403 5.75
- AA** 63-81 Shaft Retaining Clip 3787806 2.75
- BB** 63-66 Clutch Pedal with Shaft USA 3851223 72.00
- 63-66 Pedal Bracket with Pin USA 3851225 24.00
- BB** 67 Clutch Pedal with Shaft USA 3851224 79.00
- 67 Pedal Bracket with Pin USA 3851226 19.50
- BB** 68-79 Clutch Pedal with Pin 3787820 71.95
- BB** 80-81 Clutch Pedal with Pin 3787819 85.00
- CC** 63 Fork Rod Spring Repto 3787400 5.00
- CC** 63 Fork Rod Spring NOS 3787803 20.00
- DD** 64-81 Fork Rod Springs 2 reqd 3787501 3.50
- EE** 63-67 Firewall Return Spring 3787807 6.00
- DD** 68-81 Firewall Return Spring 3787808 6.50

Clutch Return Spring Brackets

EE 63-66 Clutch Return Spring Bracket authentic hooked bracket mounts to firewall at the steering column bracket, for attachment of the clutch return spring. 3787812 5.00

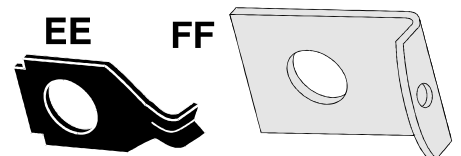

FF 67 Clutch Return Spring Bracket authentic hooked bracket mounts to firewall at the steering column bracket, for attachment of the clutch return spring. 3787813 3.00

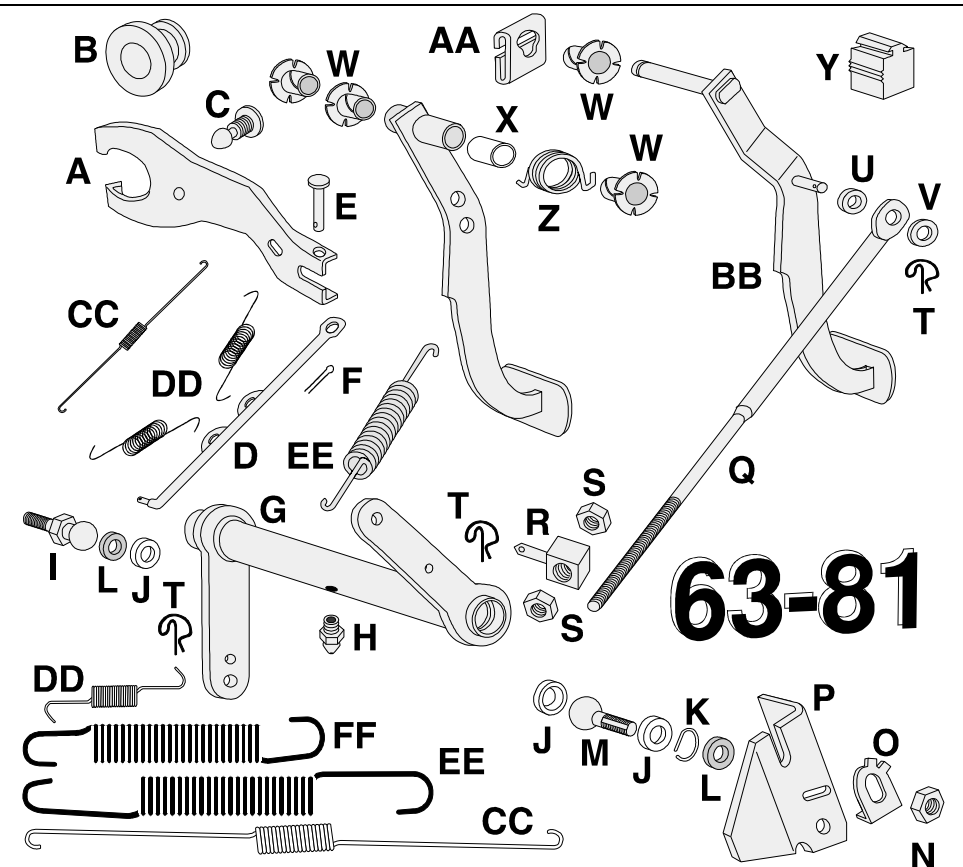

63-81